



EUROPEAN YACHTING NETWORK

## TUKKER KOTTER (1987)

Property: 43.710.2508



EYN Price: **€ 39.500**

Length: 11,00 m; Width: 3,50 m; Draft: 1,20 m; Headroom: 1,95 m; Engine brand: DAF DH825; Total engine power: 139 hp; Engine hours: 3.335 hour; Number of engines: 1 ; - : Shipyard ; Trade: Negotiable ; Private Financing: Possible ;



EUROPEAN YACHTING NETWORK

### The yacht

<b>Brand</b>	TUKKER
<b>Type</b>	KOTTER
<b>Boat type</b>	Motor boat
<b>Name of the boat</b>	BORRICO
<b>BTW/VAT</b>	Paid
<b>Year of construction</b>	1987
<b>Berth</b>	West-Vlaanderen - België

### Sizes & Weights

<b>Length</b>	11,00 m
<b>Width</b>	3,50 m
<b>Draft</b>	1,20 m
<b>Headroom</b>	1,95 m

### The engine

<b>Engine brand</b>	DAF DH825
<b>Total engine power</b>	139 hp
<b>Engine hours</b>	3.335 hour
<b>Last service</b>	02-01-2016
<b>Fuel tank capacity</b>	1.500 l



EUROPEAN YACHTING NETWORK

#### \* POSSIBILITIES

<b>Status</b>	Super sale!
<b>Private Financing</b>	Possible
<b>Berth</b>	Transmissible
<b>Trade</b>	Negotiable
<b>Suitable for habitation</b>	Yes

#### DECK EQUIPMENT

<b>Material deck</b>	Steel
<b>Anchor</b>	Electrical
<b>Options present</b>	Swimming platform Rail Bimini top

#### ELECTRONICS

<b>Voltage circuit</b>	24v + 220v
<b>Heating</b>	diesel

#### ENGINE ROOM

<b>Number of engines</b>	1
<b>Fuel</b>	Diesel

#### GALLEY

<b>Cooking ring</b>	Gas
<b>Options present</b>	Oven Geyser Sink

#### INTERIOR LAYOUT

<b>Berths</b>	6
<b>Bedrooms</b>	3
<b>Window frames</b>	Aluminium
<b>Bathroom</b>	1
<b>Options present</b>	Aft cabin Front cabin



EUROPEAN YACHTING NETWORK

Dinette

#### MATERIALS INTERIOR

<b>Ceiling</b>	Wood
-	Shipyard
<b>Floor covering</b>	Hout
<b>Seats</b>	Fabric
<b>Options present</b>	Curtains

#### NAVIGATION

<b>Bow thruster</b>	Electric
<b>Options present</b>	Mariphone
	Compass
	Depth gauge
	GPS

#### OTHER

<b>Dinghy</b>	None
---------------	------

#### TECHNICAL DETAILS

<b>Type of engine</b>	Inboard
<b>Technical condition below the waterline</b>	Good condition
<b>Material (hull)</b>	Steel
<b>Anti fouling</b>	Done 2015

#### WET ROOM

<b>Toilet</b>	1
<b>Shower</b>	1
<b>Bathrooms</b>	1



EUROPEAN YACHTING NETWORK

Bötenbouw Tukker  
Spijke dijk 2a  
4204 GN Gorinchem  
Tel 01830-36428

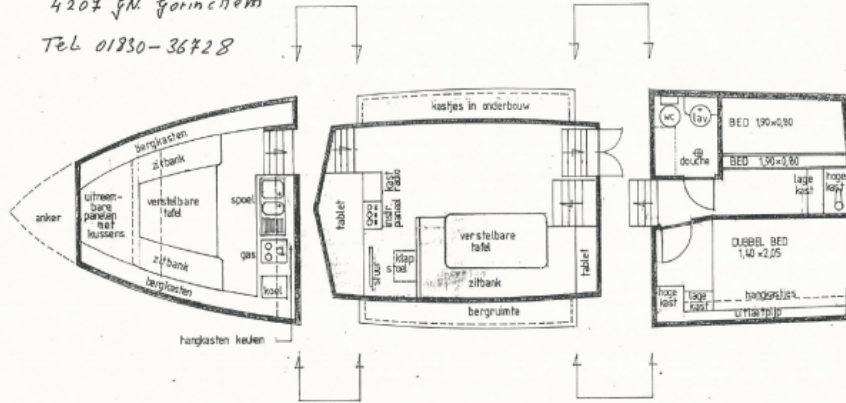

Botticelli  
bericeo-II

a. vandenbogaerde kuurne

056.714050



EUROPEAN YACHTING NETWORK





**EUROPEAN YACHTING NETWORK**





EUROPEAN YACHTING NETWORK







EUROPEAN YACHTING NETWORK

